

INSTALLAZIONE: Sottotop

MODELLO: CINZIA SOTTOTOP

78,4 x 48 2V	Base 900 Foro sottotop: 734 x 430	Base 900 Undertop hole: 734 x 430
--------------	--------------------------------------	--------------------------------------

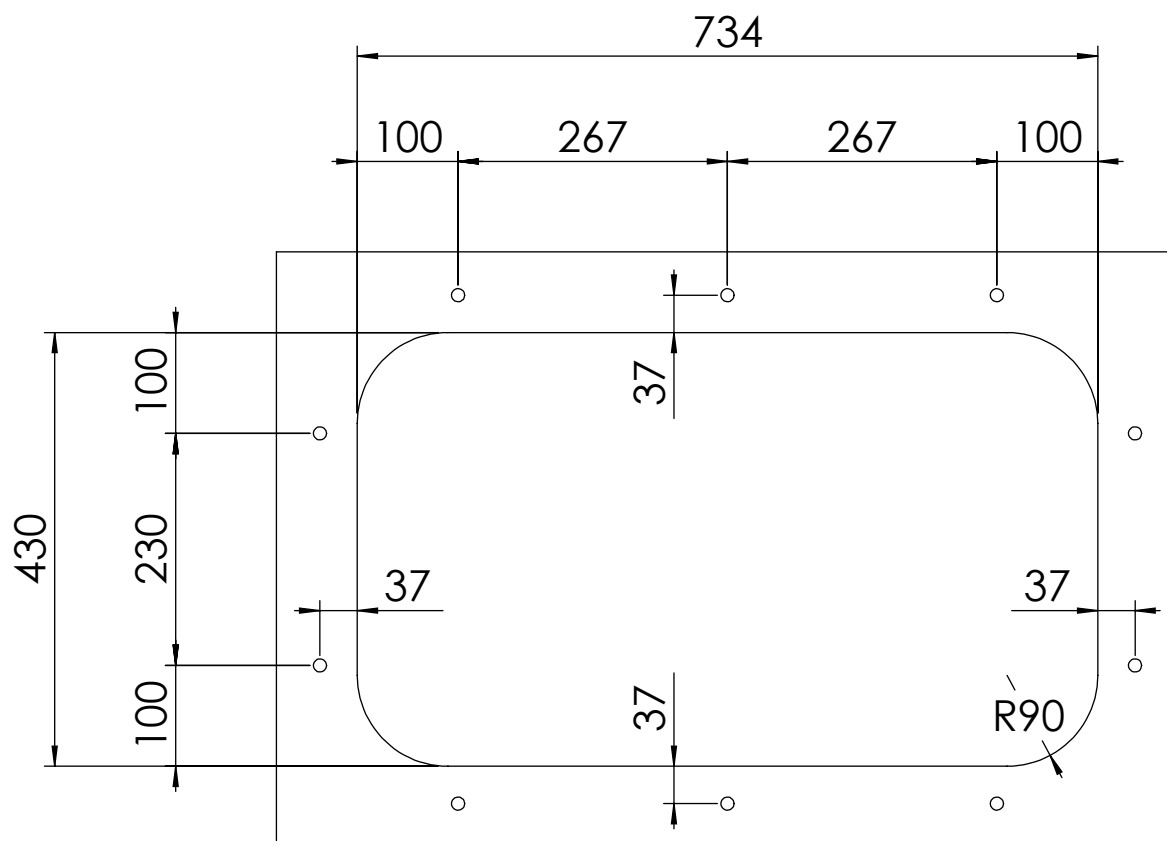

N° 10 fori \varnothing 13 mm profondità 15 mm

10 holes, each \varnothing mm 13 depth 15